

46 **Chinook**

Windy
Soleil by Scandinavia





Spirit of Scandinavia recognized worldwide

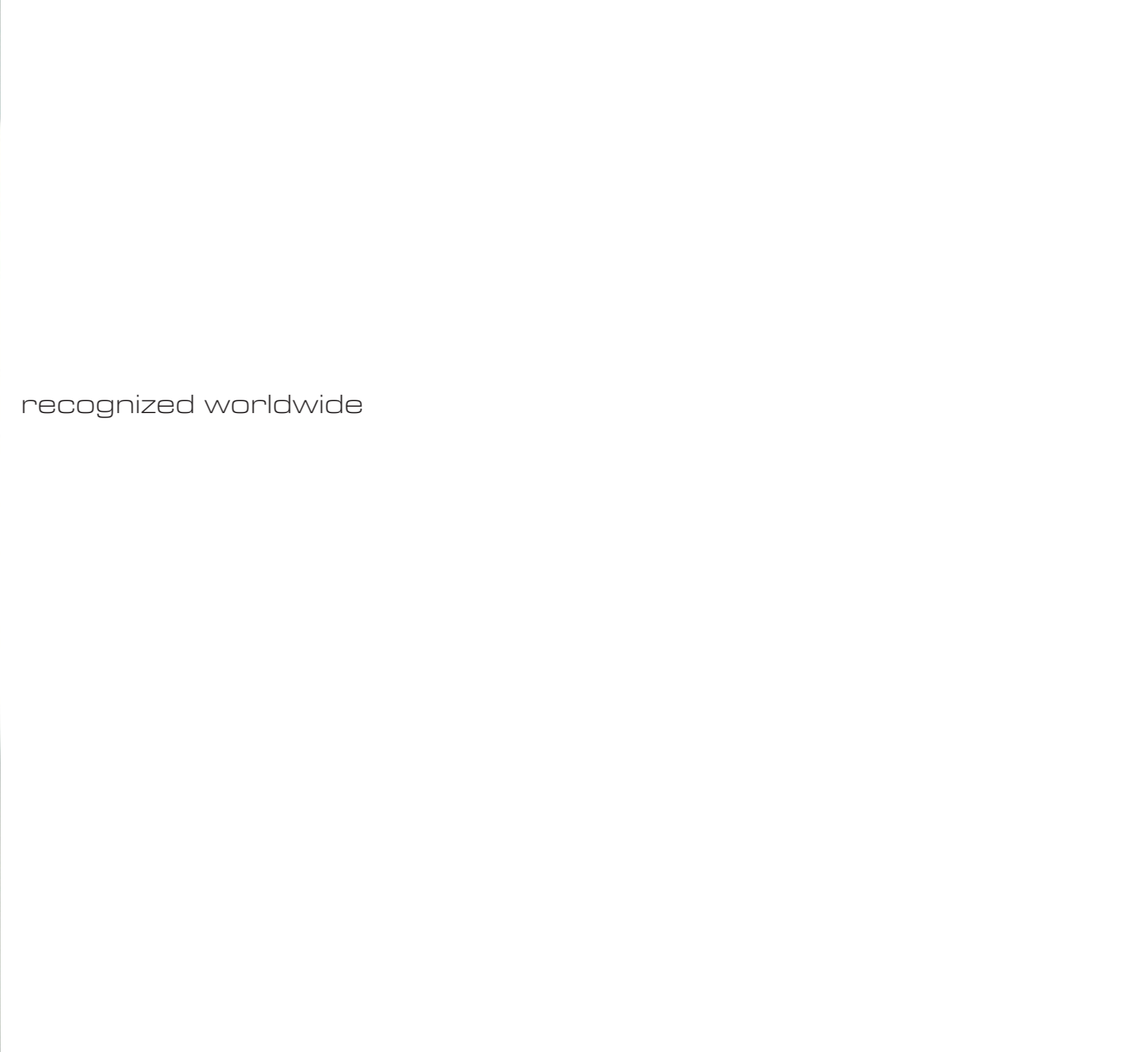

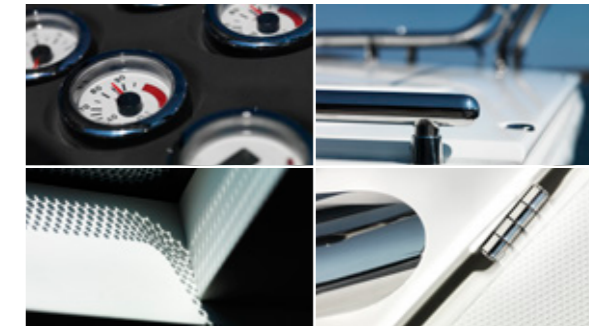

PRECISION ENGINEERED,
HAND FINISHED

Windy's reputation is built on quality and craftsmanship. Our award-winning deep v-hulls are renowned for delivering an exhilarating, yet stable and dry ride. Our production facilities in Västervik and Ostroda are among the most advanced in Europe, employing resin transfer moulding to produce stronger, lighter, more fuel-efficient hulls. Distinctive interiors by leading superyacht designers combine clean Scandinavian lines with luxurious detailing. And every boat is hand-finished with Windy's customary perfectionism using the highest quality components and finest materials. For Windy customers, only the best will do.





46 **Chinook**

Widely acclaimed as the best sport cruiser of her size, the 46 Chinook builds on a winning mix of excellent family accommodation and unbeatable handling and performance. Like her predecessors, the 44 and 45, she is a true offshore performance yacht designed for those who dream of venturing further afield in luxury and comfort. With a sleek hardtop and extended sun roof as standard, the 46 is well suited to hot or cooler climates. Her large sociable cockpit has plenty of space to relax or entertain, and feels safe and secure under way, even in more challenging conditions.





All our models are hand-built by skilled craftsmen. The fine woodwork and exclusive textiles are important distinguishing features of a WINDY.

Pride in craftsmanship is something that has been handed down through centuries of Norwegian boat building. Today we are honoring these traditions and our heritage from locations outside Norway, yet in areas with long maritime history and proficient craftsmen.



Available with a choice of Volvo Penta sterndrive or IPS engines and standard Humphree interceptors the 46 offers some of the best economy figures in her class, combined with a top speed of 40 knots. She also comes with a much expanded options list including a longer hydraulic platform and retractable letterbox gangway.

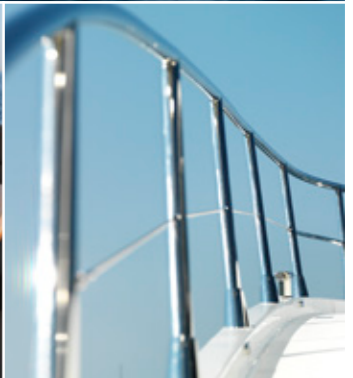



Windy

Raymarine



Down below, this family-friendly cruiser unusually offers three spacious cabins and two ensuite shower compartments. The superyacht standard interiors are by renowned designer, Peder Eidsgaard, and feature plenty of natural light and panoramic windows in the saloon.







Deck fittings & equipment

All fittings crafted and cast from highest grade stainless steel
 Stainless deck cleats x8
 Pulpit and rails in stainless steel
 Stainless bow roller and anchor stop
 Stainless Bruce anchor (20 kg). 50 m chain
 Reversible anchor winch 700W, operated from deck or helm
 Chain lockers - fender stowage
 Starboard fresh water filler (1)
 Holding tank w/ electric pump
 Decksides discharge-point for holding tank
 Flag pole and ensign socket
 Signal horn
 Navigation lights
 Down lights on aft deck

Cockpit saloon

Hard Top in GRP with large electrically operated canvas sunroof
 Self-draining cockpit
 Manually operated side window on starboard side
 Main AC/ DC control panel
 Comfortable seating for 6-7
 Storage under seating
 Handcrafted cockpit table in finest wood
 Full cockpit service area with refrigerator and sink
 Hot and cold water
 Glass holders
 Overhead LED lights
 Dimmer for overhead LED lights
 Main switch and circuit breaker panel
 FUSION 750 radio with Bluetooth
 230V socket for wet bar
 Electrically adjustable Cockpit table
 Canopy in canvas fabric

Aft lounge area

Manually operated engine room hatch
 Open aft deck with entrance to bathing platform

Helmman's and co-pilot positions

Helm position bridge with individual pilot and co-pilot chairs/
 bench 1+3
 Nextel antiglare surface on dashboard
 Heavy duty windscreen wipers x2
 Single electronic lever engine controls
 Full analogue engine instrumentation
 Updated switch panel for all service functions
 Fresh water and fuel gauges
 Chart area
 Compass
 USB socket/port
 Hand- held fire extinguishers (2kg)
 Glass holders
 Windscreen washer
 Demisting / Defroster system
 Chartplotter Raymarine eS127
 VHF Ray 260
 FUSION 750 radio with Bluetooth
 Steering wheel upgrade to Sport version
 Electronic steering
 Humphree interceptors (Auto-trim and Auto-list)

Main saloon

Interior woodwork in finest wood
 Oak floor
 Overhead cupboards
 Overhead LED lights
 Dimmer for overhead LED lights
 Access to midships heads and shower room
 TV with tuner in saloon or in forward stateroom
 Blinds

Galley

Galley top in high-grade composite material
 Sink with hot & cold water
 Gas cooktop with oven
 Extractor fan over hob
 Electric refrigerator (85 litres)
 Cupboard and drawers for storage
 Separate storage compartments underneath galley floor
 Rubbish bin
 2x 230V / 1x USB socket
 Oak floor
 Blinds

Electrical equipment

Electrical system 12 volt
 5x Engine/Domestic AGM batteries
 Holding tank w/ electric pump
 Fire Suppression System in engine room

Forward stateroom

Double berth with high-quality sprung mattress
 Skillfully crafted woodwork
 Full hanging wardrobe
 Lights in wardrobe
 Overhead lockers
 Lockers for personal items
 Oak floor
 Reading lights (2)
 Overhead LED lights
 Dimmer for overhead LED lights
 Opening portholes with mosquito screens (2)
 Drawers for storage
 230V / USB socket
 Direct access to forward heads and shower room
 Curtains
 Deck hatch with mosquito net and night screen
 TV with tuner in saloon or in forward stateroom

Forward stateroom en-suite shower and heads

Counter top in high-grade composite material
 Wash basin with hot and cold water
 Electric toilet
 Separate shower
 Updated flooring material
 Glass holder
 Towel hooks
 Bathroom furniture in finest wood
 Overhead lockers
 Mirror
 Overhead LED lights
 Dimmer for overhead LED lights
 Opening porthole with mosquito screen
 Extractor fan
 230V socket for shaver or hair dryer
 Blinds

Starboard centre guest cabin

2x Single berths with high-quality spring mattresses
 Skillfully crafted interior woodwork
 Oak floor
 Reading lights (2)
 Hanging wardrobe
 Lights in wardrobe
 Overhead LED lights
 Dimmer for overhead LED lights
 Opening porthole with mosquito screen
 Blinds
 230V / USB socket

Port centre guest cabin

Double berths with high-quality spring mattresses
 Skillfully crafted interior woodwork
 Hanging wardrobe
 Lights in wardrobe
 Oak floor
 Reading lights x2
 Overhead LED lights
 Dimmer for overhead LED lights
 Blinds
 Opening porthole with mosquito screen
 230V / USB socket

Center shower and heads

Counter top in high-grade composite material
 Wash basin with hot and cold water taps and accessories
 Electric heads
 Separate shower
 Updated flooring material
 Glass holder
 Towel hooks
 Skillfully crafted interior woodwork
 Overhead lockers
 Opening porthole with mosquito screen
 Mirrored cupboard
 Overhead LED lights
 Dimmer for overhead LED lights
 Extractor fan
 230V socket for shaver or hair dryer
 Blinds

Bathing and dinghy platform

Bathing ladder
 Shower with hot and cold water
 Teak on beach and dinghy platform
 230V Shore-power connection (incl. cable)

Overall dimentions

Length over all	14,15 m (excl. Pulpit)
Beam	3,98 m
Height	4,75 m
Weight	10 700 kg (incl. std Engine)
Fuel	1070 L
Fresh water	300 L
Berths	6 persons
CE Classification	B
Exterior design and styling	WINDY
Interior design	WINDY
Naval Architect	Hans Jørgen Johnsen

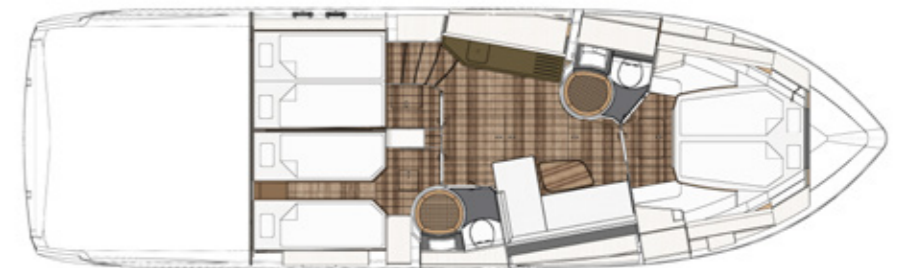
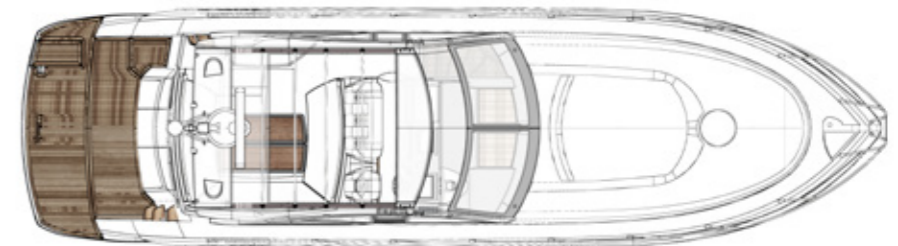

FIRST FOR QUALITY

When Windy Boats was established in 1966 our first sport boats set new standards for performance and craftsmanship. 50 years on, we're still driven by the urge to be the best. All Windy Boats bear the hallmark of quality without compromise, drawing on five decades of boatbuilding excellence, and centuries of Scandinavian seafaring heritage. Put simply, we build better boats because we're Windy. It's in our DNA.





Windy Boats pursues a policy of continuous product innovation and enhancement. Everything presented in this brochure is subject to change without prior notice. This brochure must therefore be taken only as non-binding guidelines from Windy Boats • The images shown in this brochure do not necessarily show standard boats and cannot therefore be used as references for the standard specification for each individual model • All boats manufactured by Windy Boats are approved for specific categories by RINA and are CE-labelled • Every attempt is made to ensure that all information in this brochure is as accurate as possible, but it is important to note that a boat's performance and test data are given only as guidance • Fouling of the hull and stern gear, by for example marine growth and mud, propeller damage, engine set-up, engine manufacture and type, air and water temperatures, the weight of fuel, water, stowage and the number of persons on board may all affect the boats' performance and test data. For these and other reasons, Windy Boats is unable to provide any guarantee of test data and boat performance • Graphic design: Jan Peter Lehne • Printed by Tellogruppen • Exterior and interior photos: JP Lehne • Windy Boats reserves all rights in this brochure. Reproduction prohibited without written authorisation by the copyright holder • Windy Oceancraft, Draco Oceancraft, Draco and WinTec are trademarks of Windy Boats AS



WINDY BOATS AS • SKARPNES • BOX 40 • N-4854 NEDENES • NORWAY
windyboats.com

WINDY SCANDINAVIA AB • SÖDRA VARVSGATAN 27 • SE-593 50 VÄSTERVIK • SWEDEN • TEL.: +46 490 258 850
info@windyboats.com